

T 1 - 2 = 238,0 mm
T 2 - 3 = 261,0 mm

A-A (1 : 1)

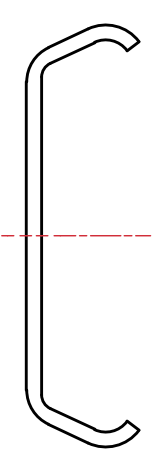

HDA

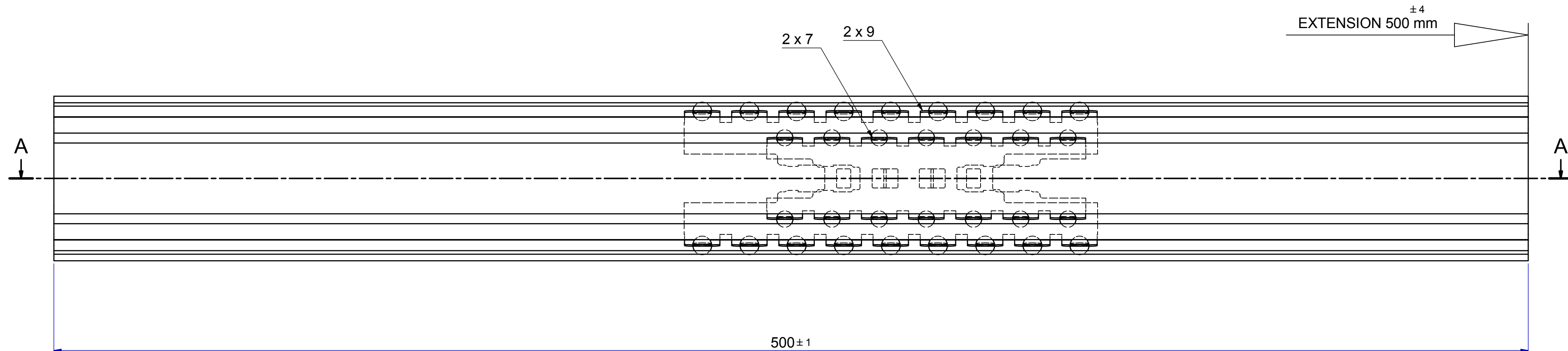
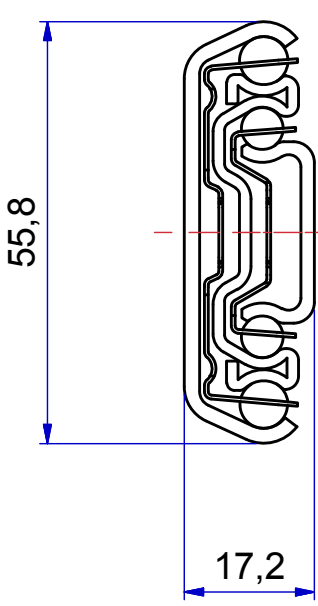
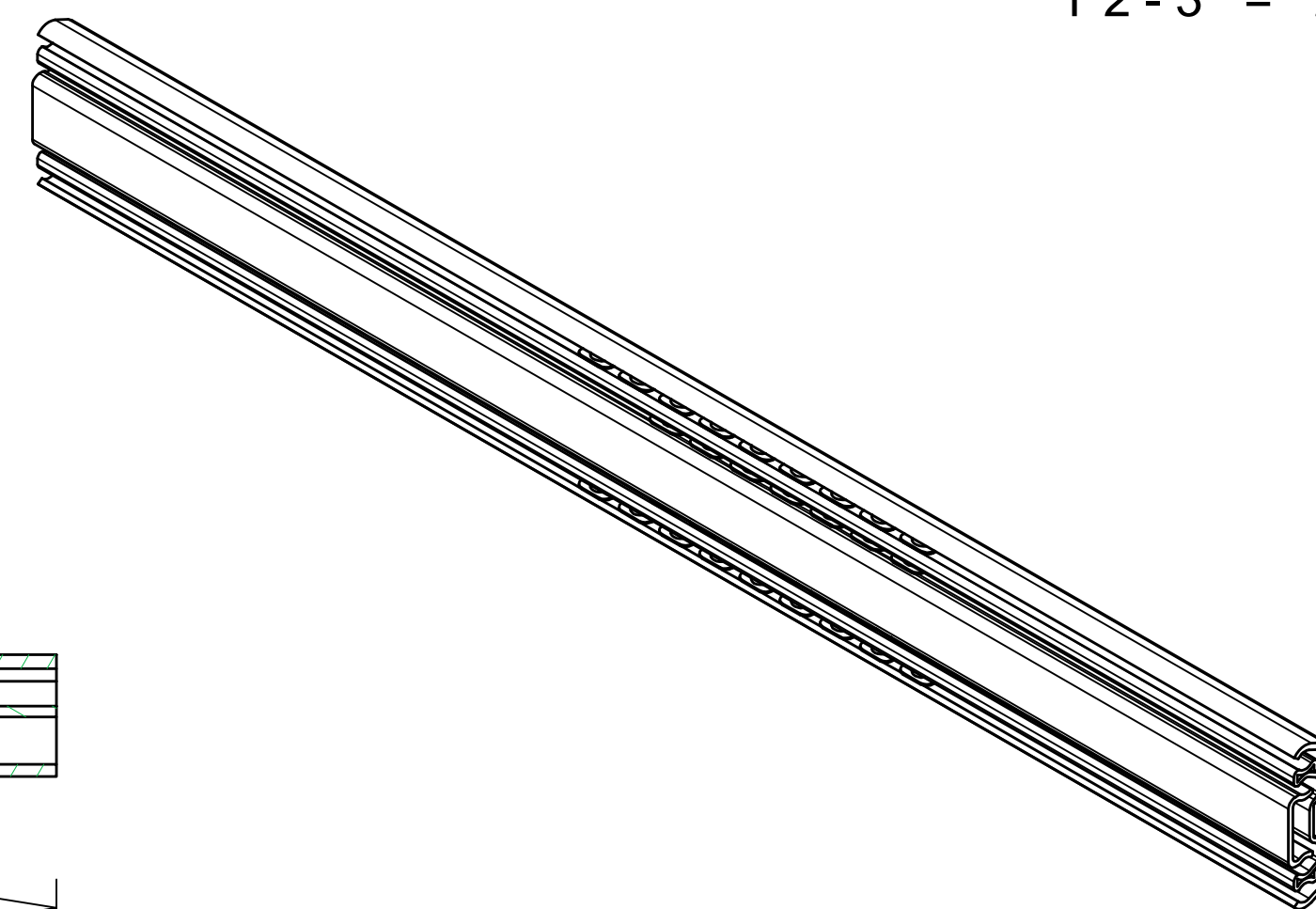
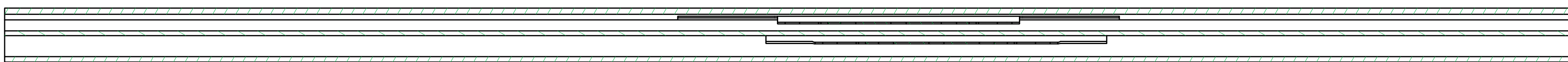
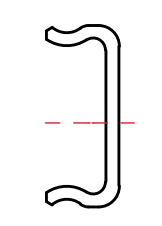
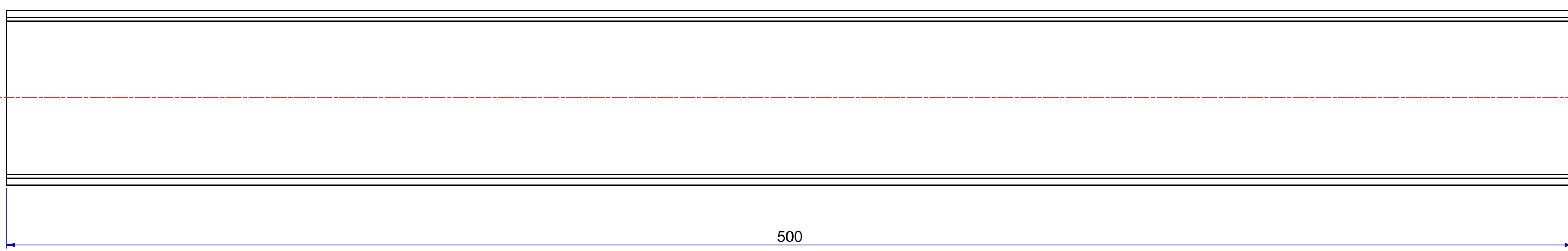

UB3

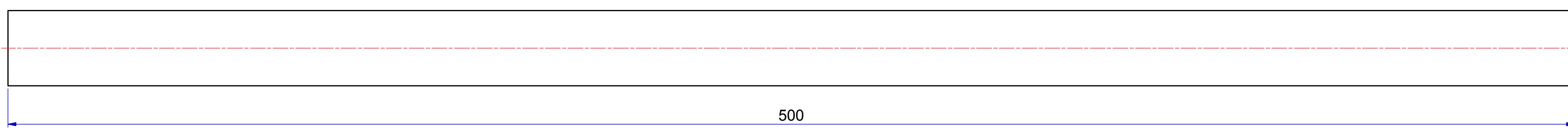

**OTHER DIMENSIONS NEEDED?
CUSTOM MADE SLIDES AVAILABLE UPON REQUEST.**

Right hand slide = Left hand slide.
Dimensions between marks are guide dimensions.
Thomas Regout Int. B.V. reserves the right to alter non-customer specific specifications without notice.

Designer	W.Jans	Gen.Tol.Dim.	± 0,5	Third angle projection	Material
Date	11-6-2015	Gen.Tol.Angle	± 0,5		Treatment
Approver		Gen.Roughness	Ra		Draw type
Date		Units	mm/deg.	Scale	1 : 1
Description				Type	Model No. E000031752
ULF HD 500.0 / 500.0 (17,2mm)				Released for Production	
Format	A1			Item No.	ULF HD 17.2
© THOMAS REGOUT INTERNATIONAL BV, Industrieweg 40, 6219 NR, Maastricht, The Netherlands, +31 (0)43 351 66 66					Revision
					00