

T 1-2 = 5,406 in
T 2-3 = 6,327 in

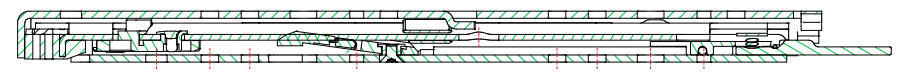

A-A (1:1)

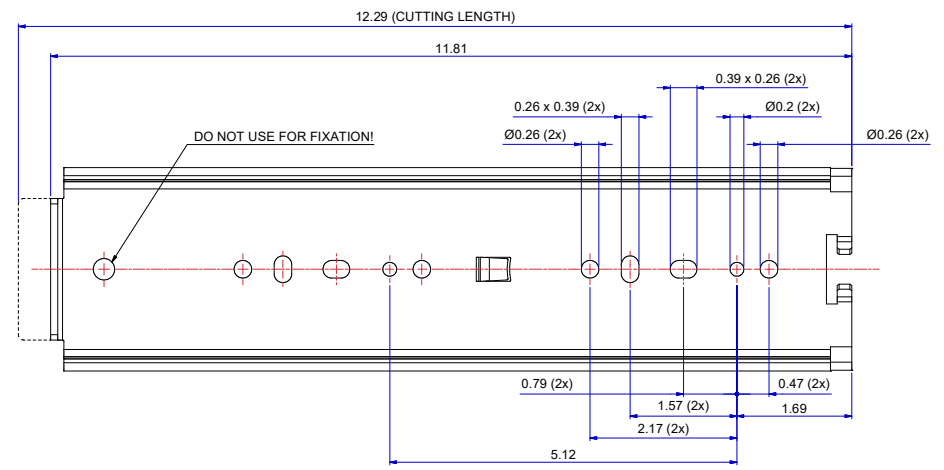
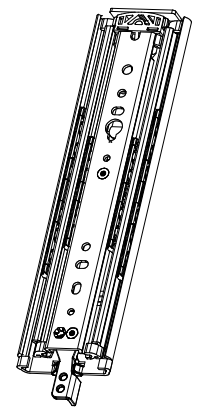
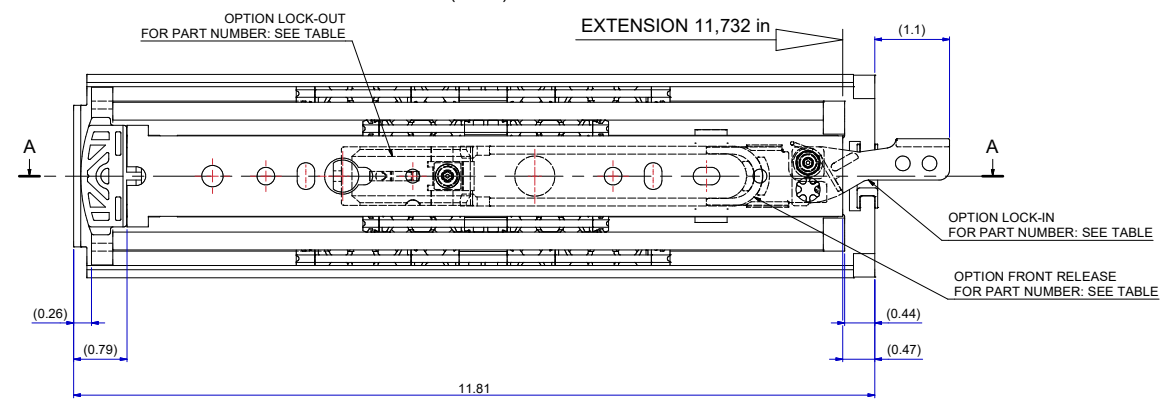
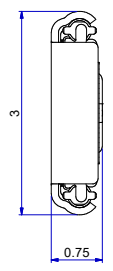

FRONT

511-14-S31-TC1

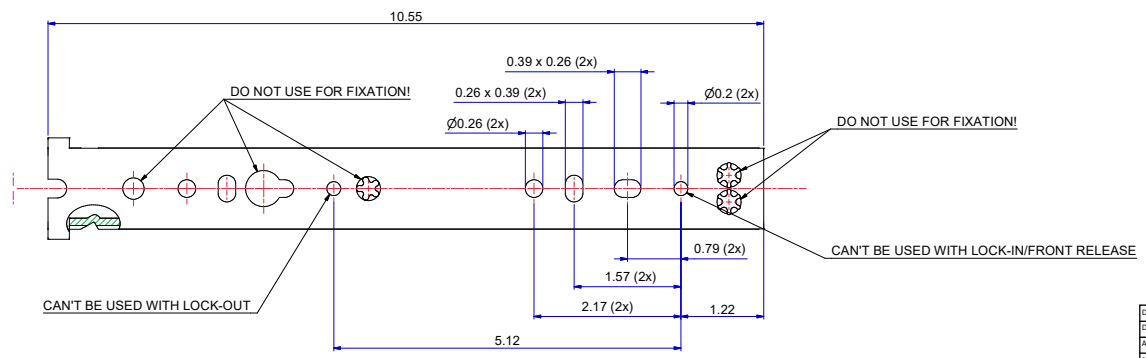

SLIDE
RIGHT HAND = LEFT HAND
LOCK-IN/FRONT-RELEASE
RIGHT HAND SIDE SHOWN, LEFT HAND SIDE IS MIRRORED

DIMENSIONS ARE CALCULATED FROM METRIC VALUES.
DIMENSIONS BETWEEN MARKS ARE GUIDE DIMENSIONS.
THOMAS REGOUT INT. B.V. RESERVES THE RIGHT TO ALTER
NON-CUSTOMER SPECIFIC SPECIFICATIONS WITHOUT NOTICE.

513-14-S31-TC3

Designer	R. Cornelisse	Gen.Tol.Dim.	± 0.5	Third angle projection	Material
Date	11-2-2021	Gen.Tol.Angle	± 0.5	Treatment	
Approver		Gen.Roughness	Ra	Draw type	Fabrication
Date		Units	mm/deg.	Scale	1 : 1
Description				Type	Model No. E00012303
TR7619 300 / 298 (19,1mm)				Released for Production	

Format	A1	STANDARD	114S31	LOCK-IN	114S31A	LOCK-OUT	114S31B	LOCK-IN & LOCK-OUT & FRONT-RELEASE	114S31D	Item No.	114-S31	Revision	00
© THOMAS REGOUT INTERNATIONAL B.V. Industrieweg 40, 6219 NR, Maastricht, The Netherlands, +31 (0)43 351 66 66 All rights are reserved.													