

A-A (1:2)

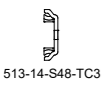
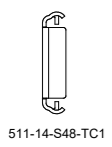
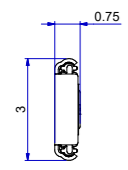
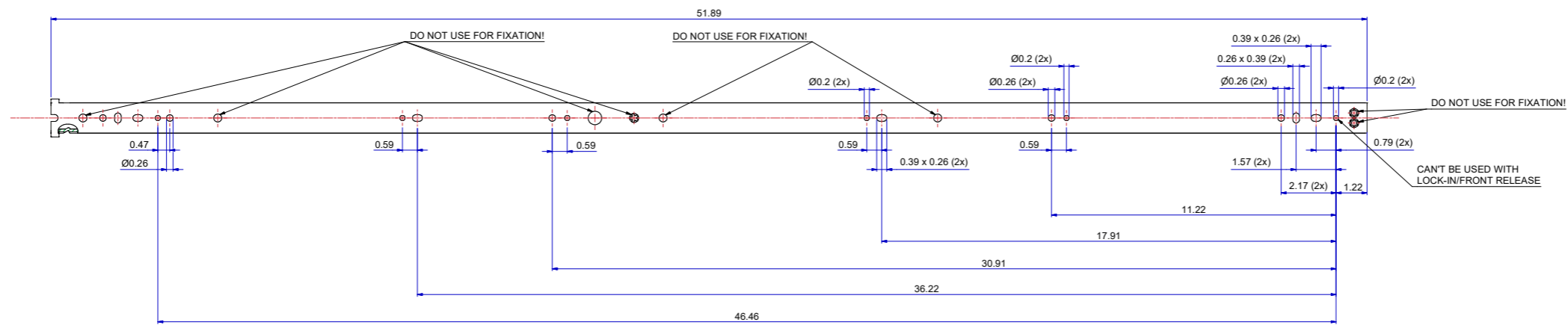
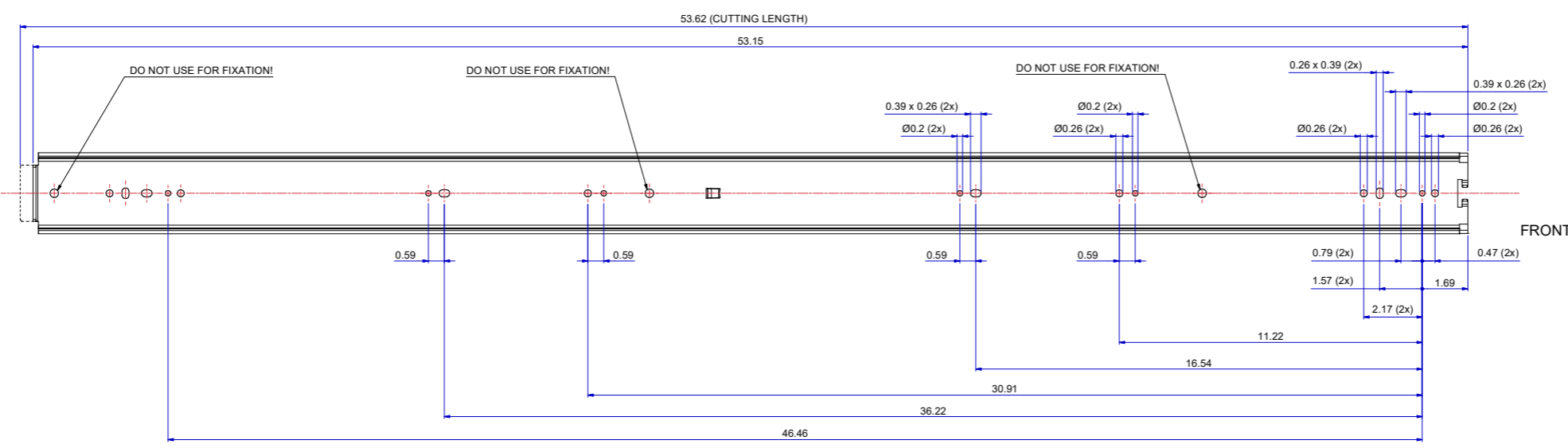
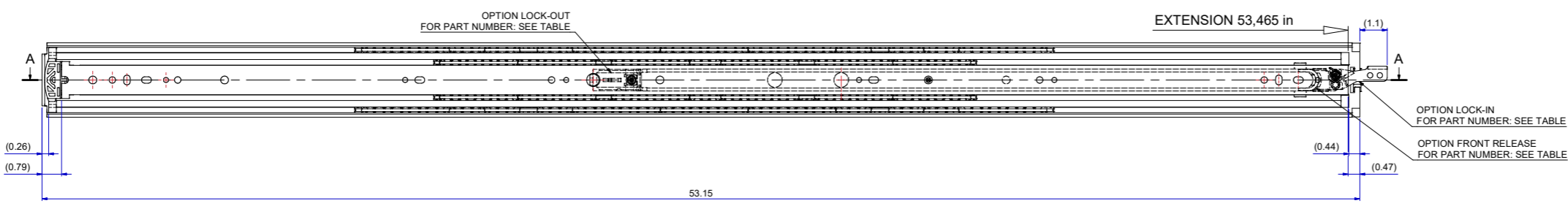

SLIDE
RIGHT HAND = LEFT HAND
LOCK-IN/FRONT-RELEASE
RIGHT HAND SIDE SHOWN, LEFT HAND SIDE IS MIRRORED

DIMENSIONS ARE CALCULATED FROM METRIC VALUES.
DIMENSIONS BETWEEN MARKS ARE GUIDE DIMENSIONS.
THOMAS REGOUT INT. B.V. RESERVES THE RIGHT TO ALTER
NON-CUSTOMER SPECIFIC SPECIFICATIONS WITHOUT NOTICE.

Designer: R. Cornelissen	Gen. Tol. Dim. ± 0.5	Third angle projection	Material
Date: 11-2-2021	Gen. Tol. Angle ± 0.5		Treatment
Approver: Gen. Rougiers	Ra	Draw type: Fabrication	Doc. No. E000117563
Date:	Units: mm/deg.	Scale: 1 : 2	Model No. E000012303

Description: TR7619 1350 / 1358 (19,1mm)		Released for Production
Format: A0	THOMAS REGOUT INTERNATIONAL B.V.	Item No. 114-S48
Part Number: 114S48	Lock-In: 114S48A	Lock-Out: 114S48B
Lock-In & Lock-Out & Front-Release: 114S48D	© THOMAS REGOUT INTERNATIONAL B.V., Industrieweg 40, 6219 NR, Heerlen, The Netherlands, +31 (0)43 251 66 66	All rights are reserved.